

## Cooling System for AMI 207 Orbital Welder Power Supply

*A CSI Designed Innovation for Ease of Use, Improved Quality, and Increased Productivity in Orbital Welding*

Unlike many chillers or cooling units that rely on the orbital welder power supply, CSI's patented cooling system is independently powered.

- Runs on its own standard power supply (110AC)
- Results in more consistent welds, since the power isn't pulled off of the welder
- Continuously cools the weld head, even after the weld is finished (manual shut-off)
- Filter is easily accessible for cleaning
- Simple visual flow gauge vs. complicated/expensive magnetic impeller designs in competitive models
- New motor/pump combination for twice the flow capacity of competitive models
- Pump features a heavy duty rebuildable brass housing vs. competitor's plastic throwaway models
- Reusable filter element with twice the surface area of competitive elements
- Dual cooling fans mounted to the heat exchanger vs. a single fan on competitive cooling systems

CSI Chillers can be purchased, and come standard with any AMI 207 / 217 orbital equipment rental.

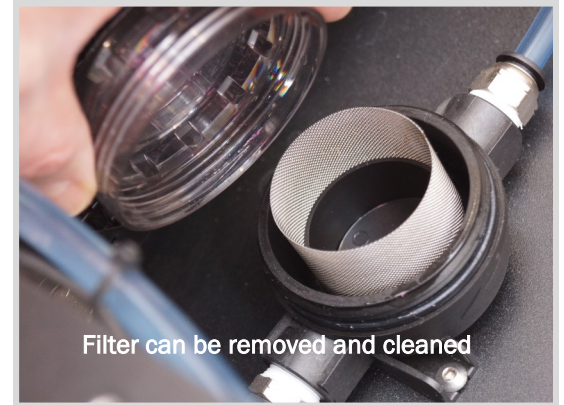

Since 2000, Critical Systems, Inc. (CSI) has been supporting the breakthrough technologies of our customers with practical, cost effective solutions that “surround the process tool”.

7000 West Victory Road · Boise, ID 83709 · (877) 572-5515 · [www.criticalsystemsinc.com](http://www.criticalsystemsinc.com)